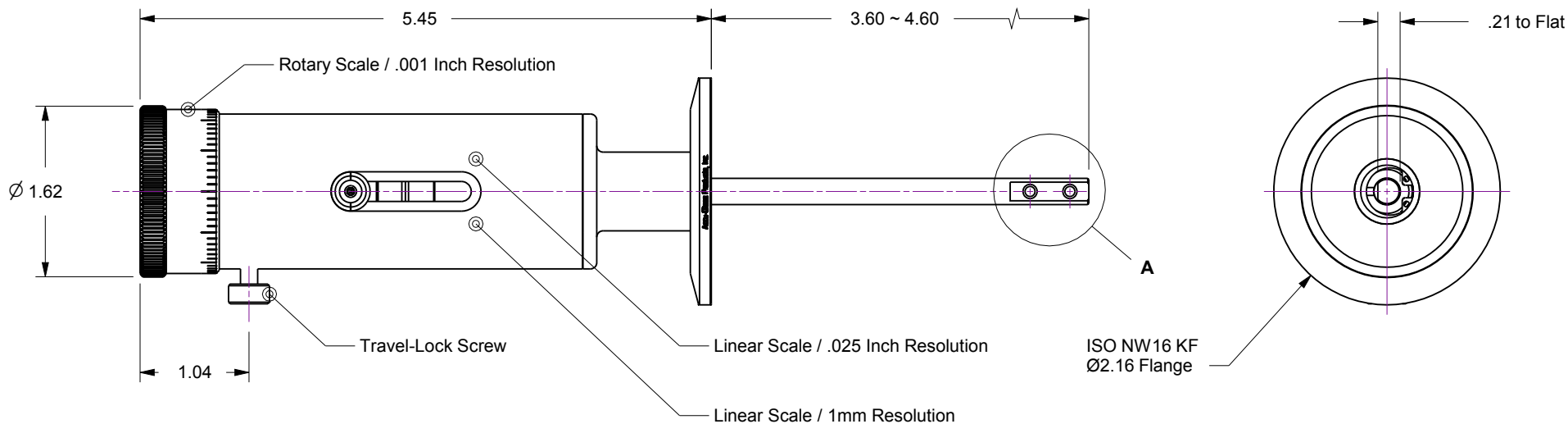
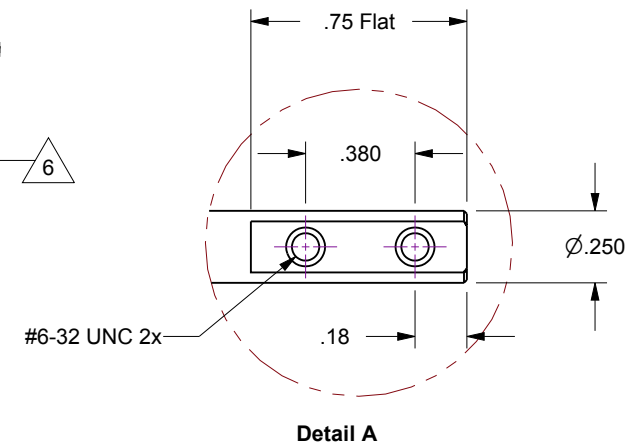
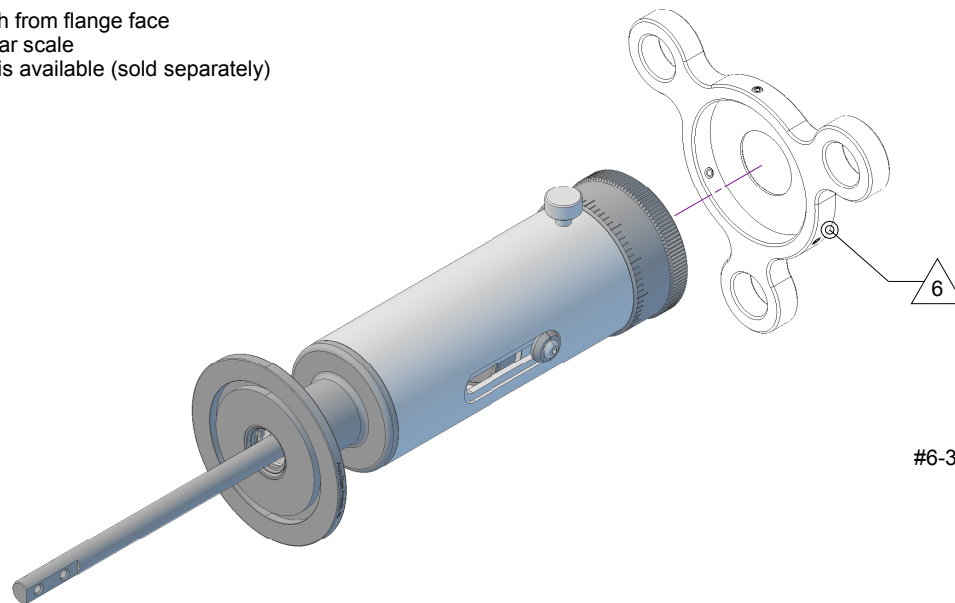

Notes

1. HTL-K40-1... 1-Inch Linear Travel Feedthrough w/Manual Actuator
2. Welded bellows sealed air-to-vacuum interface
3. Leak test to 5x10E-10 Standard cc/sec of He
4. Maximum Loads : 5lb Axial / 5lb Lateral @ 2-Inch from flange face
5. Resolution : .001 Rotary scale / .025 Inch Linear scale
6. Optional 'Speed-Handle' part number 113086 is available (sold separately)

Rev.	Description	Date	Made By	Approval
B	Remodeled	4/8/2019	AL	

**UNCONTROLLED WEB DRAWING**

Proprietary and Confidential
The information contained in this drawing is the sole property of Accu-Glass, Products Inc. Any reproduction, in part or as whole, without the written permission of Accu-Glass Products, Inc., is strictly prohibited.

Material
See Individual Components

Tolerances,
unless otherwise specified

.X ± .030	Angles ± 0.5° Finish 63Ra
.XX ± .010	
.XXX ± .005	

Title

HTL-K40-1

Drawn by
Date

Ligeti
4/8/2019

No. **102270**

Rev.

B

Approved

Sheet



Accu-Glass Products Inc.
25047 Anza Drive
Valencia, CA 91355
T 818-365-4215
F 818-365-7074
www.accuglassproducts.com