

Notes

1. HTL-K16-1... 1-Inch Linear Travel Feedthrough w/Manual Actuator
2. Welded bellows sealed air-to-vacuum interface
3. Leak test to 5x10E-10 Standard cc/sec of He
4. Maximum Loads : 5lb Axial / 5lb Lateral @ 2-inch from flange face
5. Resolution : .001 Rotary scale / .025 inch Linear scale
6. Optional 'Speed-Handle' part number 113086 is available (sold separately)

| Rev. | Description | Date | Made By | Approval |
|------|-------------|----------|---------|----------|
| B | Remodeled | 4/4/2019 | AL | |

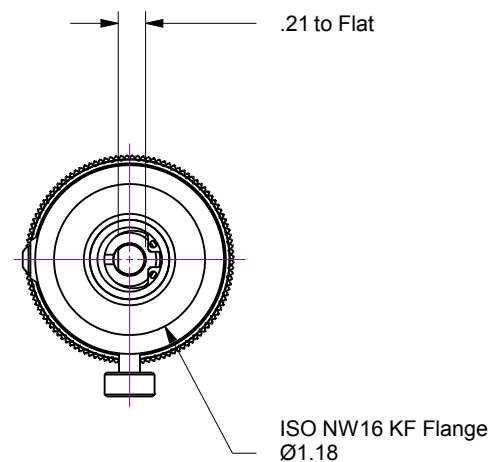
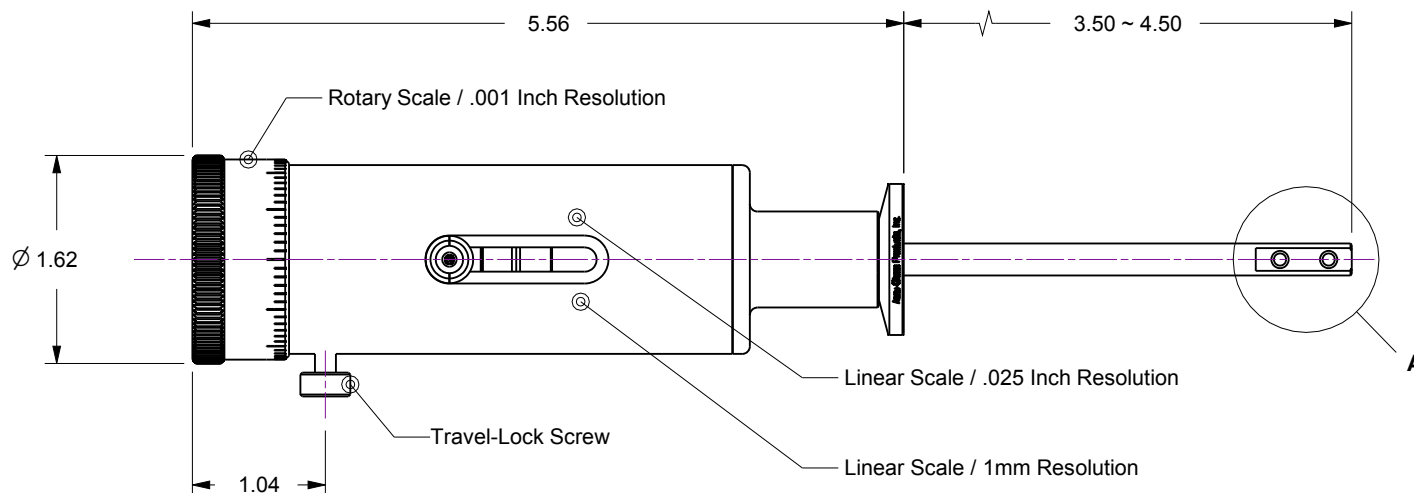
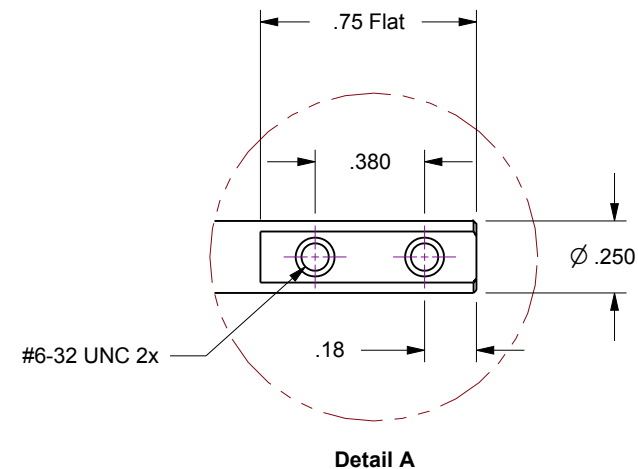
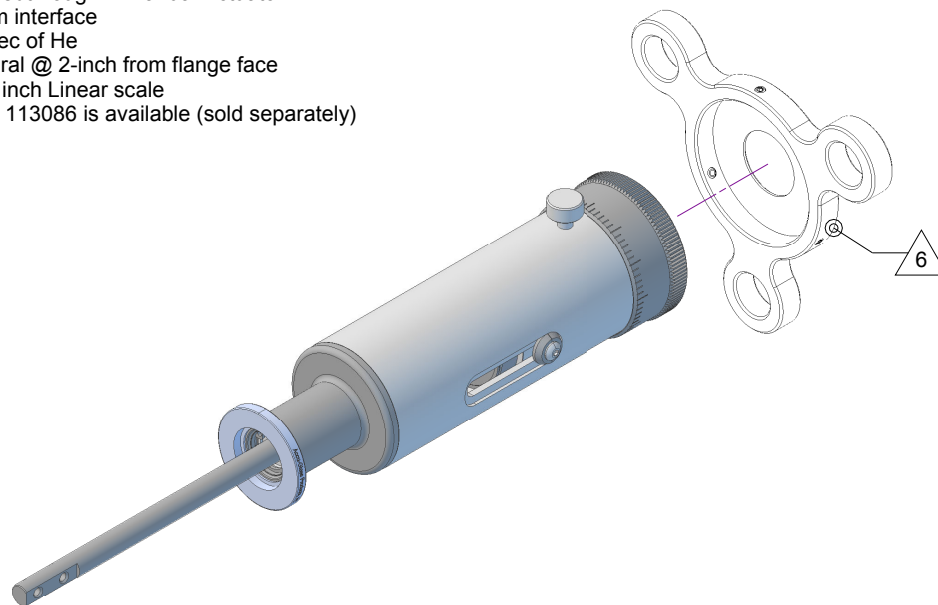

Accu-Glass Products Inc.
25047 Anza Drive
Valencia, CA 91355
T 818-365-4215
F 818-365-7074
www.accuglassproducts.com

UNCONTROLLED WEB DRAWING

Proprietary and Confidential
The information contained in this drawing is the sole property of Accu-Glass, Products Inc. Any reproduction, in part or as whole, without the written permission of Accu-Glass Products, Inc., is strictly prohibited.

Material
See Individual Components

Tolerances,
unless otherwise specified

| | |
|-------------|------------------------------|
| .X ± .030 | Angles ± 0.5° Finish 63Ra |
| .XX ± .010 | |
| .XXX ± .005 | |

Title

HTL-K16-1

Drawn by
Date

Ligeti
4/4/2019

No. **102250**

Rev.

B

Approved

Sheet